

## Hand Tools WERA

### Wera 6000 Joker Ratcheting combination wrenches

Fine tooth mechanism with 80 teeth in all, which provides greater flexibility, even in very confined spaces. Take it easy tool finder with profile and size colour-coding for quick and easy tool selection. Practical holding function thanks to the metal plate in the jaw. Limit stop prevents any slipping. The double-hex geometry reduces the risk of slipping. Return angle of only 30°. The Joker's holding function means that nuts and bolts can be held in the jaw and easily positioned where they are needed. Fastening to the thread can then be done quickly and safely, thanks to innovative special stop-plate which holds the fastener. No more time-wasting searches for dropped nuts and bolts!. After applying and positioning the nut or bolt, fastening can begin immediately - no additional tools required. The Joker's clever double-hex geometry delivers a very positive connection with nuts and bolts, it's a perfect fit. Available in Metric and Imperial.



Article No.	Type	Description	IMPA
96W05073268	6000	Wera 6000 Joker Ratcheting combination wrench 8 mm	-
96W05073270	6000	Wera 6000 Joker Ratcheting combination wrench 10 mm	-
96W05073271	6000	Wera 6000 Joker Ratcheting combination wrench 11 mm	-
96W05073272	6000	Wera 6000 Joker Ratcheting combination wrench 12 mm	-
96W05073273	6000	Wera 6000 Joker Ratcheting combination wrench 13 mm	-
96W05073274	6000	Wera 6000 Joker Ratcheting combination wrench 14 mm	-
96W05073275	6000	Wera 6000 Joker Ratcheting combination wrench 15 mm	-
96W05073276	6000	Wera 6000 Joker Ratcheting combination wrench 16 mm	-
96W05073277	6000	Wera 6000 Joker Ratcheting combination wrench 17 mm	-
96W05073278	6000	Wera 6000 Joker Ratcheting combination wrench 18 mm	-
96W05073279	6000	Wera 6000 Joker Ratcheting combination wrench 19 mm	-

Article No.	Type	Description	IMPA
96W020013	6000	Wera 6000 Joker Ratcheting combination wrench set 11 pcs 8-10-11-12-13-14-15-16-17-18-19 mm	-

### Wera 6001 Joker Ratcheting combination wrenches with switching lever

Fine tooth mechanism, which provides greater flexibility, even in very confined spaces. Take it easy tool finder with profile and size colour-coding for quick and easy tool selection. Practical holding function thanks to the metal plate in the jaw. Limit stop prevents any slipping. The double-hex geometry reduces the risk of slipping. Return angle of only 30°. Ratchet end angled by 15°. The Joker's holding function means that nuts and bolts can be held in the jaw and easily positioned where they are needed. Fastening to the thread can then be done quickly and safely, thanks to innovative special stop-plate which holds the fastener. No more time-wasting searches for dropped nuts and bolts!. After applying and positioning the nut or bolt, fastening can begin immediately - no additional tools required. The Joker's clever double-hex geometry delivers a very positive connection with nuts and bolts, it's a perfect fit. Available in Metric and Imperial.

Article No.	Type	Description	IMPA
96W05020064	6001	Wera 6001 Joker Ratcheting combination wrench 8 mm	-
96W05020065	6001	Wera 6001 Joker Ratcheting combination wrench 10 mm	-
96W05020066	6001	Wera 6001 Joker Ratcheting combination wrench 11 mm	-
96W05020067	6001	Wera 6001 Joker Ratcheting combination wrench 12 mm	-
96W05020068	6001	Wera 6001 Joker Ratcheting combination wrench 13 mm	-
96W05020069	6001	Wera 6001 Joker Ratcheting combination wrench 14 mm	-
96W05020070	6001	Wera 6001 Joker Ratcheting combination wrench 15 mm	-
96W05020071	6001	Wera 6001 Joker Ratcheting combination wrench 16 mm	-
96W05020072	6001	Wera 6001 Joker Ratcheting combination wrench 17 mm	-
96W05020073	6001	Wera 6001 Joker Ratcheting combination wrench 18 mm	-
96W05020074	6001	Wera 6001 Joker Ratcheting combination wrench 19 mm	-

Article No.	Type	Description	IMPA
96W020091	6001	Wera 6001 Joker Ratcheting combination wrench set 11 pcs 8-10-11-12-13-14-15-16-17-18-19 mm	-

Article No.	Type	Description	IMPA
96W05020075	6001	Wera 6001 Joker Ratcheting combination wrench 5/16"	-
96W05020076	6001	Wera 6001 Joker Ratcheting combination wrench 3/8"	-
96W05020077	6001	Wera 6001 Joker Ratcheting combination wrench 7/16"	-
96W05020078	6001	Wera 6001 Joker Ratcheting combination wrench 1/2"	-
96W05020079	6001	Wera 6001 Joker Ratcheting combination wrench 9/16"	-
96W05020080	6001	Wera 6001 Joker Ratcheting combination wrench 5/8"	-
96W05020081	6001	Wera 6001 Joker Ratcheting combination wrench 11/16"	-
96W05020082	6001	Wera 6001 Joker Ratcheting combination wrench 3/4"	-

Article No.	Type	Description	IMPA
96W020093	6001	Wera 600 Joker Ratcheting combination wrench set 8 pcs 5/16"-3/8"-7/16"-1/2"-9/16"-5/8"-11/16"-3/4"	-

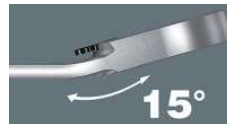

# Hand Tools WERA

## Wera 6003 Joker combination wrenches

Especially suitable for tight spaces. The special mouth geometry expands the placement possibilities of the tool. The low return angle in the mouth "takes" the screw every 15°. Slim ring side with 15° crank. "Take it easy tool finder" with profile and size colour-coding for quick and easy tool selection. The Joker 6003 ring spanner with its special mouth geometry-mouth side pivoted by 7,5° and the double hexagon profile doubles the placement possibilities when repeatedly turning the wrench 180° around the longitudinal axis. Bolts and screw heads can be "accessed" every 15°. The Joker 6003 will automatically find the respective placement point after every turn. The double hexagon geometry on the mouth and ring sides secures the positive connection with the screw head or bolt and reduces the risk of slipping. The ring side is cranked at 15° to the tool axis to prevent injury. Available in Metric and Imperial.

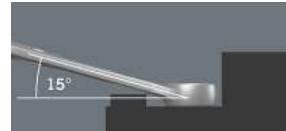

Article No.	Type	Description	IMPA	Article No.	Type	Description	IMPA
96W05020190	6003	Wera 6003 Joker 5,5 mm	-	96W05020208	6003	Wera 6003 Joker 17 mm	-
96W05020198	6003	Wera 6003 Joker 6 mm	-	96W05020209	6003	Wera 6003 Joker 18 mm	-
96W05020199	6003	Wera 6003 Joker 7 mm	-	96W05020210	6003	Wera 6003 Joker 19 mm	-
96W05020200	6003	Wera 6003 Joker 8 mm	-	96W05020500	6003	Wera 6003 Joker 20 mm	-
96W05020219	6003	Wera 6003 Joker 9 mm	-	96W05020501	6003	Wera 6003 Joker 21 mm	-
96W05020201	6003	Wera 6003 Joker 10 mm	-	96W05020502	6003	Wera 6003 Joker 22 mm	-
96W05020202	6003	Wera 6003 Joker 11 mm	-	96W05020503	6003	Wera 6003 Joker 24 mm	-
96W05020203	6003	Wera 6003 Joker 12 mm	-	96W05020504	6003	Wera 6003 Joker 27 mm	-
96W05020204	6003	Wera 6003 Joker 13 mm	-	96W05020505	6003	Wera 6003 Joker 30 mm	-
96W05020205	6003	Wera 6003 Joker 14 mm	-	96W05020506	6003	Wera 6003 Joker 32 mm	-
96W05020206	6003	Wera 6003 Joker 15 mm	-	96W05020507	6003	Wera 6003 Joker 36 mm	-
96W05020207	6003	Wera 6003 Joker 16 mm	-				



Article No.	Type	Description	IMPA
96W020230	6003	Wera 6003 Joker Combination wrench set 5 pcs 8-10-13-17-19 mm	-



## Wera 950/9 Hex-Plus Multicolour HF 1 L-Key set BlackLaser with holding function

Hex-Plus allows socket head screws to live longer. L-keys with retaining function for hexagon socket screws. Hexagonal ballpoint on the long arm. With take it easy tool finder; colour coding by size. Colour coded, easy grip-to-grip plastic sleeve, even at low temperatures. The clamping of the screw is achieved by a flexible locking ball. The holding function is especially helpful in confined, hard-to-reach spaces, where there is no room for a second hand to secure the screw on the tool. The spherical drive profile means that it is possible to swivel the axis of the tool to that of the screw, and therefore enable angled, "around-the-corner" screwdriving jobs. Thermoplastic sleeves fit better into the hand and are made from circular material.



Article No.	Type	Description	IMPA
96W022210	950/9	Hex-Plus set 9 pcs, 1.5-2-2.5 mm L-key multicolour, 3-4-5-6-8-10 mm HF L-key multicolour with <b>holding function</b>	-
96W022089	950/9	Hex-Plus set 9 pcs, 1.5-2-2.5-3-4-5-6-8-10 mm L-key multicolour	-
96W022640	950/9	Hex-Plus set 9 pcs, 3/8"-5/16"-1/4"-7/32"-3/16"5/32"-1/8"-3/32"-5/64" L-key multicolour	-



## Wera 3950/9 Hex-Plus Stainless 1 L-Key set

Solution to the extraneous rust problem; fasten stainless screws with stainless tools. Hex-Plus allows socket head screws to live longer. Stainless L-keys prevent extraneous rust on stainless steel screws. L-keys are quickly to hand thanks to their size markings. Wear-resist clip material for enhanced durability. Stainless L-keys are hardened to the same strength as conventional (carbon) steel tools. The size of each L-key has been engraved by a laser. In addition "Take-it-easy" L-keys have a colour coding according to sizes for simple and rapid accessing of the required tool. Each size L-key can be ordered separately.

Article No.	Type	Description	IMPA
96W022720	3950/9	Hex-Plus set 9 pcs, 1.5-2-2.5-3-4-5-6-8-10 mm L-key Stainless Steel	-
96W022721	3950/9	Hex-Plus set 9 pcs, 3/32"-7/64"-1/8"-9/64"-5/32"-3/16"-1/4"5/16"3/8" L-key Stainless Steel	-
96W022669	3950/9	Hex-Plus set 9 pcs, 1.5-2-2.5-3-4-5-6-8-10 mm L-key Stainless Steel L-key multicolour	-



Wera Stainless Steel Tools are vacuum ice hardened to work in industrial applications with no limitations.

Wera Colour Coding system for quick and easy identification of the tool size.



Wera Coloured Thermoplastic Sleeve for easy-to-grip. Made from circular material. Works safe and comfortable even at low temperatures.



## Hand Tools WERA

### Wera 967/9 TX 1 L-key set BlackLaser, 9 pcs

L-keys for recessed TORX screws. BlackLaser for high corrosion protection and long service life. L-keys are quickly to hand thanks to their size markings. Wear-resistant clip material ensures secure storage of the L-keys as well as simple removal. TORX ballpoint on the long arm. The spherical drive profile means that it is possible to swivel the axis of the tool that of the screw, and therefore enable angled, "around-the-corner" screwdriving jobs. The size of each L-keys has been engraved by laser.



Article No.	Type	Description	IMPA
960080	967/9 TX L-key	Wera 967/9TX 1 L-key set BlackLaser 9 pcs contains: 967 PKL TORX L-key Black laser 1 pcs each  TX8 x 76, TX9 x 79, TX10 x 85, TX15 x 90, TX20 x 96, TX25 x 104, TX27 x 112, TX30 x 122, TX40 x 132 mm.	-



### Wera Kraftform Kompakt Zyklop Speed, 26 pcs

Combines five different types of a ratcheted in one. Flywheel design and easy-to-grip free-turning sleeve for very high working speeds. Can also be used as a screwdriver. Fine-toothing for small return angle. Pouch for belt attachment. The Zyklop 6 in 1 fine tooth ratchet with a flex head, angle ratchet, quick release ratchet, power ratchet and screwdriver. The ratchet head pivots freely and can be locked into any defined position by using the slide switch that is positioned on each side. A really fast mover as screwdriver. Simple direction change with the thumbwheel. The reversible ratchet with 72 fine-pitched teeth has a low return angle of only 5°. This short stroke allows fast and precise work in all types of installation. Ratchet can be used as a conventional screwdriver in 0° position by attaching a bitholder adaptor and a bit.



Article No.	Type	Description	IMPA
960070	Zyklop	Wera Kraftform Kompakt Zyklop Speed 26 pcs contains: 8000A Zyklop Speed Ratchet with 1/4" Drive 8784A1 Zyklop Bit Adaptor 1/4" 8794LA Zyklop extension with free-turning sleeve long 1/4"x150 851/4 TZ Bits 1x PH1x50, 1x PH2x50, 1x PH3x50 855/4 TZ Bits 1x PZ1x50, 1x PZ2x50 867/4 Z Torx Bits 1x T10x50, T15x50, T20x50, T25x50, T27x50, T30x50 800/4 Z Bits 1x 5.5x50 840/4 Z Bits 1x 3x50, 4x50, 5x50, 6x50 8790 HMA Zyklop 1/4" socket 5,5, 6, 7, 8, 10, 12, 13 mm	-



### Wera Tool-Check PLUS, 39 pcs

Convenient direct change thanks to switchover lever. Fine-pitched ratched mechanism and small return angle of 6°. Very robust without any restrictions on torque. Quick-release chuck with Rapidaptor Technology. With Take it easy tool finder; colour coding by size. The Zyklop Mini Ratchets for all difficult-to-access applications. Fine tooth mechanism with it's 60 teeth, allows small return angle of only 6°, ideal for precision work. Simple switching between left/right operation. Rapid screwdriving with the thumbwheel. Slim design for confined working situations. The Zyklop Mini 1 ratchet can withstand at least 65 Nm, which is more power than normally can be transferred to such a small tool. The Bit-Check itself can be used as a lever.

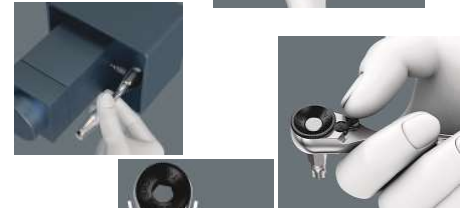

Article No.	Type	Description	IMPA
96W056490	PLUS	Wera Tool-Check PLUS 39 pcs contains: 8001A Bit Ratchet with 1/4" Drive 813 Bitholding screwdriver 1/4" 889/4/1 K Rapidaptor Universal Bit Holder 1/4" x 50 mm 870/1 Adaptor 1/4" x 25 mm (with friction ball, for manual nut spinner sockets) 8790 HMA Zyklop 1/4" socket 5,5, 6, 7, 8, 10, 12, 13 mm 851/1 TZ Bits 1x PH1x25, 1x PH2x25, 1x PH3x25 855/1 TH Bits 1x PZ1x25, 1x PZ2x25, 1x PZ3x25 867/1 TZ Torx Bits 1x T10x25, T15x25, T20x25, T25x25, T27x25, T30x25 867/1 Z Torx BO bits with bore hole 1x T10x25, T15x25, T20x25, T25x25, T30x25 801/1 TZ Bits 1x 5.5x25 840/1 Z Bits 1x 3x25, 4x25, 5x25, 6x25, 8x25	-



### Wera Kraftform Kompakt 62, 33 pcs

Pouch with 89 mm-long bits. Kraftform holder with Rapidaptor quick-release chuck allows rapid bit change. Tough viscous bits for universal use. Suitable for manual and power tool operations. The handle/interchangeable blade system allows rapid exchange of the blades required for a wide range of applications. The Rapidaptor quick-release chuck holds 1/4" DIN ISO 1173-C 6,3 and E 6,3 as well as Wera series 1 and 4 bits. Hex-Plus tools have a greater contact surface and prevent damaging of the hexagon screws. The TRI-WING screwdriving system is mainly found in aviation and household technology. The high-precision Wera profile design ensures a secure fit of the tool in the head of the screw. The TORQ-SET Mplus profile has stronger flanks in compare with tools with a conventional TORQ-SET. This result in approx. 70% extra torsional strength and greatly extends the service life of Wera MPlus tools.



Article No.	Type	Description	IMPA
96W059297	Kompakt 62	Wera Kraftform Kompakt 62, 33 pcs contains: 816 R Bitholding screwdriver with Rapidaptor Quick-release chuck 1/4" x 119 mm 851/4 Z Bits 1x PH1x89, 1x PH2x89, 1x PH3x89 855/4 Z Bits 1x PZ1x89, 1x PZ2x89, 1x PZ3x89 867/4 Z Torx BO Bits with bore hole 1x T8x89, T10x89, T15x89, T20x89, T25x89, T27x89, T30x89, T40x89 800/4 Z Bits 1x 1.2x6.5x89 840/4 Z Tamper-proof Hex-Plus BO Bits 1x 2x89, 2,5x89, 3x89, 4x89, 5x89, 6x89 871/4 TORQ-SET Mplus Bits 1x 6x89, 8x89, 10x89 875/4 TRI-WING Bits 1x 1x89, 2x89, 3x89, 4x89 857/4 Z Spanner Bits 1x 4x89, 6x89, 8x89, 10x89	-



## Hand Tools WERA

### Wera 88/1 Vario Set, 11 pcs

Vario set with handle and 10 combination blades. Smooth hard zones for high speed turning, soft grip zones for high torque transfer. Chrome-plated hexagonal blade material, 6 mm. Black point tip offers a perfect fit with optimised corrosion protection. In a robust belt pouch. The handle interchangeable blade system allows rapid exchange of the blades required for a wide range of applications. The 6 mm double-ended blades of 175 mm length are out of high quality bit material which gives them particularly long service life. The Kraftform handle fits perfectly into the hand and prevents hand injuries.



Article No.	Type	Description	IMPA
96W002990	Vario Set 88/1	Wera 88/1 Vario Set, 11 pcs contains: 80 Vario Handle 6x98 mm 85 Combination blade for Phillips screws 1x PH1 x PH2 x 175 86 Combination blade for Pozidrive screws 1x PZ1 x PZ2 x 175 87 Combination blade for Torx screws 1x TX10 x TX15 x 175, 1x TX20 x TX25 x 175, 1x TX30 x TX40 x 175 81 Combination blade for slotted screws 1x 0.6x4 x 1x6x175, 1x 0.8x5 x 1.2x7x175 84 Combination blade for hexagon socket screws 1x 4 x 175, 1x 5 x 175, 1x 6 x 175	-

### Wera 8100SA 6 Zyklop Speed Ratchet 1/4" set metric, 28 pcs

Freely pivoting ratchet head with 5 predefined locking positions. Free-returning sleeve for high working speeds. With easy tool finder; colour coding by size. The Zyklop 6 in 1 fine tooth ratchet with a flex head, angle ratchet, quick release ratchet, power ratchet and screwdriver. The ratchet head pivots freely and can be locked into any defined position by using the slide switch that is positioned on each side. A really fast mover as screwdriver. Simple direction change with the thumbwheel.

The reversible ratchet with 72 fine-pitched teeth has a low return angle of only 5°. This short stroke allows fast and precise work in all types of installation.

Ratchet can be used as a conventional screwdriver in 0° position by attaching a bitholder adaptor and a bit.

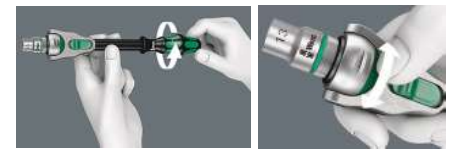

Article No.	Type	Description	IMPA
96W004016	Zyklop 8100SA	Wera Kraftform Kompakt Zyklop Speed 26 pcs contains: 8000A Zyklop Speed Ratchet with 1/4" Drive 8790 HMA Zyklop 1/4" socket 5, 5,5, 6, 7, 8, 10, 12, 13 mm 8784A1 Zyklop Bit Adaptor 1/4" 8794A Zyklop wobble extension 1/4" x 56 mm 8794LA Zyklop extension with free-turning sleeve long 1/4"x150 851/4 TZ Bits 1x PH1x50, 1x PH2x50, 1x PH3x50 855/4 TZ Bits 1x PZ1x50, 1x PZ2x50 867/4 Z Torx Bits 1x T10x50, T15x50, T20x50, T25x50, T27x50, T30x50 840/4 Z Bits 1x 3x50, 4x50, 5x50, 6x50	-

### Wera Kraftform Kompakt 70 Universal, 32 pcs

Strong permanent magnet that also holds large and heavy screws. Rapidaptor quick-release chuck allows rapid bit change. Tough viscous bits for universal use. In a robust storage box. The handle/interchangeable blade system allows rapid exchange of the blades required for a wide range of applications. Suitable for manual and power tool operations. The Rapidaptor quick-release chuck holds 1/4" DIN ISO 1173-C 6,3 and E 6,3 as well as Wera series 1 and 4 bits. Rapid in self-lock, the bit can be pushed into the adaptor without moving the sleeve and locks automatically. Simply Rapid-out of the bit by push the sleeve forward.



Article No.	Type	Description	IMPA
960383	Kompakt 70	Wera Kraftform Kompakt 70 Universal, 32 pcs contains: 816 R Bitholding screwdriver with Rapidaptor Quick-release chuck 1/4" x 119 mm 889/4/1 K Rapidaptor Universal Bit Holder 1/4"x50 851/1 TZ Bits 1x PH1x25, 1x PH2x25, 1x PH3x25 855/1 TZ Bits 1x PZ1x25, 1x PZ2x25, 1x PZ3x28 867/1 TZ Torx BO Bits with bore hole 1x T10x25, T15x25, T20x25, T25x25, T30x25, T40x25 800/1 TZ Bits 1x 0.6x4.5x25, 1x55x25, 1.2x6.5x25 840/1 TZ Bits 1x 4x25, 5x25, 6x25	-

### Wera Kraftform Kompakt VDE 16 Extra Slim, 16 pcs

VDE interchangeable blade with reduced shaft diameter. Multi-component VDE-insulated Kraftform handle with anti-roll feature. Ergonomic Kraftform handle for low-fatigue working. In robust pouch. Individually tested at 10.000 volts, in accordance with IEC 60900. This is ten-times-higher than load guarantees safe working at their maximum permitted load of 1000 volts. VDE-insulated screwdriver with reduced blade diameter with integrated protective insulation, allows sunken screws and spring elements to be accessed and actuated. Kraftform Kompakt VDE sets come with an insulated handle and insulated interchangeable blades, that can be exchanged without any special tools.



Article No.	Type	Description	IMPA
96W003484	Kompakt VDE 16	Wera Kraftform Kompakt VDE 16 Extra Slim1, 16 pcs contains: 817 VDE Kraftform blade-holding handle 9x98 mm Kraftform Kompakt VDE 62 iS 1x PH1 x 154, PH2 x 154 Kraftform Kompakt VDE 65 iS 1x PZ1 x 154, PZ2 x 154 Kraftform Kompakt VDE 65 iS PZ/S (slotted) 1, 2 x 154 Kraftform Kompakt VDE 67i TORX 1x TX10 x 154 Kraftform Kompakt VDE 67iS TORX 1x TX15, TX20, TX25 x 154 Kraftform Kompakt VDE 60iS 1x 0.6x3.5x154, 0.8x4.0x154, 1.0x5.5x154 247 Single-pole phase tester 1x 0.5x3.0x70mm	-

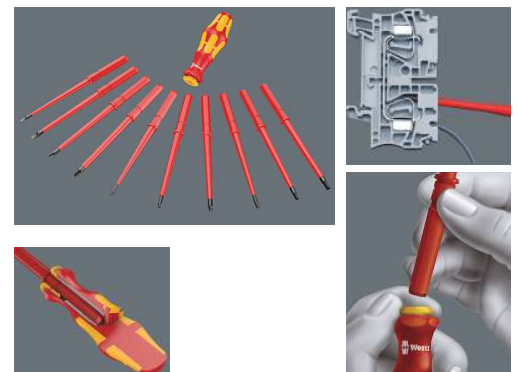

## Hand Tools WERA

### Wera Kraftform Micro screwdriver set, 12 pcs

Kraftform Micro set in a robust pouch. Kraftform Micro handle for fast and ergonomic working. The Wera Black Point tip offers an exact fit and optimum corrosion protection. Holding function for TORX screws. Take it easy tool finder; colour coding according to profile and size. E.g. for electricians, opticians, precision mechanics, IT hardware fitters etc. The free-turning cap that provides support for the hand enable quick and easy precision work. The precision zone directly above the blade gives the user a better feel for the right rotation angle during fine adjustment work. The power zone has integrated soft zones near the blade tip to ensure high torque transfer for loosening or tightening screws without losing contact with the screw. The fast turning zone just below the rotating cap allows rapid twisting.

Article No.	Type	Description	IMPA
96W073675	Kraftform Micro 12	Wera Kraftform Micro 12 Universal, 12 pcs contains: 2050 PH Phillips screwdriver 1x PH00 x 60, PH0 x 60 mm 2067 TORX screwdriver 1x TX5 x 40, TX6 x 40 mm 2035 Slotted screwdriver 1x 0.23x1.5x40, 0.30x1.8x60, 0.40x2.0x60, 0.40x2.5x80, 0.50x3.0x80 mm 2054 HEX Socket screwdriver 1x 0.9x40, 1.5x60, 2.0x60mm	-



### Wera Kraftform Micro ESD screwdriver set

ESD-safe tool thanks to surface resistance of  $\geq 10^9$  Ohm, securely protects components against electrostatic energy and associated damage. Kraftform Micro ESD bit holder. Holder with anti-roll feature, swivel cap and quick-release chuck. Bit holder suitable for the take-up of bits with 4 mm halfmoon or HIOS drive. In practical pouch. Wera ESD series satisfy the European standard DIN EN 61340-5-1. Features a combination bitholder for both bits with Halfmoon and bits with HIOS drive. Kraftform multi-component Micro handle for ergonomic working. The free-turning cap that provides support for the hand enable quick and easy precision work. The precision zone directly above the blade gives the user a better feel for the right rotation angle during fine adjustment work. The power zone has integrated soft zones near the blade tip to ensure high torque transfer for loosening or tightening screws without losing contact with the screw. The fast turning zone just below the rotating cap allows rapid twisting. Bit lengths 44 mm.

Article No.	Type	Description	IMPA
96W135973	Kraftform Micro 21 ESD	Wera Kraftform Micro 21 ESD, 21 pcs contains: 1013 Kraftform Micro ESD bitholding screwdriver 97 mm 851/9C J PH bits halfmoon 1x PH000, PH00, PH0 x 44mm 867/9C TORX bits halfmoon 1x TX1, TX2, TX3, TX4, TX5 867/9C IP TORX PLUS bits 1x 1 IP, 2 IP, 3 IP, 4 IP x 44 mm 867/9 IPR TORX PLUS bits 1x 1 IPR x 44 mm 872/9 bits for Microstix screws 1x m, 00, F, 0 x 44 mm 800/9 C slotted bits 1x 0.23x1.5, 0.35x2.5 x 44 mm 869/9 Nutsetters 1x 2.5 x 44 mm *851 000 & 00 optimised for Asian PH screws and size 0 modified according to JCIS 0 *IPR TORX PLUS without bore hole * Microstix Form A	-



Article No.	Type	Description	IMPA
96W073671	Kraftform Micro 20 ESD	Wera Kraftform Micro 20 ESD, 20 pcs contains: 1013 Kraftform Micro ESD bitholding screwdriver 97 mm 851/9C J PH bits halfmoon 1x PH00, PH0, PH1 x 44mm 867/9C TORX bits halfmoon 1x TX1, TX2, TX3, TX4, TX5, TX6 867/9C IP TORX PLUS bits 1x 1 IP, 2 IP, 3 IP, 4 IP x 44 mm 840/9 C bits HEX-PLUS 1x 1.5, 2.0 x 44 mm 867/9 IPR TORX PLUS bits 1x 1 IPR x 44 mm 800/9 C slotted bits 1x 0.23x1.5, 0.40x2.0, 0.50x3.0 x 44mm *851 00 & 1 optimised for Asian PH screws and size 0 modified according to JCIS 0 *IPR TORX PLUS without bore hole	-



### Wera 8100 SA 2 Zyklop Speed Ratchet set 1/4" set, 42 pcs

Combines five different types of a ratchet in one. Flywheel design and easy-to-grip free-turning sleeve for very high working speeds. 42-piece set in robust metall case. Freely pivoting ratchet head. With take it easy tool finder; colour coding by size. The Zyklop 6 in 1 fine tooth ratchet with a flex head, angle ratchet, quick release ratchet, power ratchet and screwdriver. The ratchet head pivots freely and can be locked into any defined position by using the slide switch that is positioned on each side. A really fast mover as screwdriver. Simple direction change with the thumbwheel. The reversible ratchet with 72 fine-pitched teeth has a low return angle of only 5°. This short stroke allows fast and precise work in all types of installation. Ratchet can be used as a conventional screwdriver in 0° position by attaching a bitholder adaptor and a bit.

Article No.	Type	Description	IMPA
960071	8100 SA2	Wera 8100 SA 2 Zyklop 1/4" set, 42 pcs contains: 8000A Zyklop Speed Ratchet with 1/4" drive x152 mm 8790 HMA Zyklop 1/4" socket 1x each 4, 4.5, 5, 5.5, 6, 7, 8, 9, 10, 11, 12, 13, 14 mm. 8789A Zyklop sliding T-handle 1/4" x 110 mm 8794A Zyklop wobble extension 1/4" x 56 mm 8795A Zyklop universal joint 1/4" x 35.5 mm 8784A1 Zyklop bit adaptor 1/4" 8796SA Zyklop flexible-lock extension free-turning sleeve short 1/4" x 75 mm 8796LA Zyklop flexible-lock extension free-turning sleeve long 1/4" x 150 mm 851/1 Z Phillips bits 1x PH1, PH2, PH3 x 25 mm 855/1 Z Pozidrive bits 1x PZ1, PZ2, PZ3 x 25 mm 867/1 Z TORX BO bits with bore hole 1x T8, T9, T10, T15, T20, T25, T30, T40 x 25 mm 840/1 Z HEX Socket bits 1x 3, 4, 5, 6, 8 x 25 mm 800/1 Z Slotted bits 1x 0.6x4.5, 1.0x5.5, 1.2x8.0 x 25 mm	-



## Hand Tools WERA

### Wera 8100 SA 6 Zyklop Speed Ratchet set 1/4" set, 28 pcs

Combines five different types of a ratchet in one. Flywheel design and easy-to-grip free-turning sleeve for very high working speeds. 42-piece set in robust pouch. Freely pivoting ratchet head. With take it easy tool finder; colour coding by size. The Zyklop 6 in 1 fine tooth ratchet with a flex head, angle ratchet, quick release ratchet, power ratchet and screwdriver. The ratchet head pivots freely and can be locked into any defined position by using the slide switch that is positioned on each side. A really fast mover as screwdriver. Simple direction change with the thumbwheel. The reversible ratchet with 72 fine-pitched teeth has a low return angle of only 5°. This short stroke allows fast and precise work in all types of installation. Ratchet can be used as a conventional screwdriver in 0° position by attaching a bitholder adaptor and a bit.



Article No.	Type	Description	IMPA
960072	8100 SA6	Wera 8100 SA 6 Zyklop 1/4" set, 28 pcs contains: 8000A Zyklop Speed Ratchet with 1/4" drive x152 mm 8790 HMA Zyklop 1/4" socket 1x each 5, 5.5, 6, 7, 8, 9, 10, 11, 12, 13 mm. 8794A Zyklop wobble extension 1/4" x 56 mm 8784A1 Zyklop bit adaptor 1/4" 8796LA Zyklop flexible-lock extension free-turning sleeve long 1/4" x 150 mm 851/4 Z Phillips bits 1x PH1, PH2, PH3 x 50 mm 855/4 Z Pozidrive bits 1x PZ1, PZ2, x 50 mm 867/4 Z TORX 1x T10, T15, T20, T25, T30, T40 x 50 mm 840/4 Z HEX Socket bits 1x 3, 4, 5, 6 x 50 mm	-



### Wera 8100 SB 2 Zyklop Speed Ratchet set 3/8" set, 43 pcs

Combines five different types of a ratchet in one. Flywheel design and easy-to-grip free-turning sleeve for very high working speeds. 42-piece set in robust pouch. Freely pivoting ratchet head. With take it easy tool finder; colour coding by size. The Zyklop 6 in 1 fine tooth ratchet with a flex head, angle ratchet, quick release ratchet, power ratchet and screwdriver. The ratchet head pivots freely and can be locked into any defined position by using the slide switch that is positioned on each side. A really fast mover as screwdriver. Simple direction change with the thumbwheel. The reversible ratchet with 72 fine-pitched teeth has a low return angle of only 5°. This short stroke allows fast and precise work in all types of installation. Ratchet can be used as a conventional screwdriver in 0° position by attaching a bitholder adaptor and a bit. The ball lock holds the socket and attachments securely, ensuring safe working. A changeover into any predefined position is completed by simply pressing the release button, this is even in the case in 90° position.



Article No.	Type	Description	IMPA
960078	8100 SB2	Wera 8100 SB 2 Zyklop 3/8" set, 43 pcs contains: 8000B Zyklop Speed Ratchet with 3/4" drive x199 mm 8790 HMB Zyklop 3/4" socket 1x each 6, 7, 8, 9, 10, 11, 12, 13, 14, 15, 16, 17, 18, 19, 20, 21, 22, 24 mm. 8789B Zyklop sliding T-handle 3/8" x 165 mm 8794B Zyklop wobble extension 3/8" x 76 mm 8795B Zyklop universal joint 3/8" x 50 mm 8784B1 Zyklop bit adaptor 3/8" 8796SB Zyklop flexible-lock extension free-turning sleeve long 3/8" x 125 mm 8796LB Zyklop flexible-lock extension free-turning sleeve long 3/8" x 200 mm 851/1 Z Phillips bits 1x PH2, PH3 x 25 mm 855/1 Z Pozidrive bits 1x PZ2, PZ3 x 25 mm 867/1 Z TORX B0 bits with bore hole 1x T10, T15, T20, T25, T27, T30, T40 x 25 mm 840/1 Z HEX Socket bits 1x 3, 4, 5, 6, 8, 10 x 25 mm 800/1 Z Slotted bits 1x 1.0x5.5 x 25 mm	-



### Wera 8000 Zyklop Speed Ratchet

Combines five different types of a ratchet in one. Flywheel design and easy-to-grip free-turning sleeve for very high working speeds. Freely pivoting ratchet head. The Zyklop 6 in 1 fine tooth ratchet with a flex head, angle ratchet, quick release ratchet, power ratchet and screwdriver. The ratchet head pivots freely and can be locked into any defined position by using the slide switch that is positioned on each side. A really fast mover as screwdriver. Simple direction change with the thumbwheel. The reversible ratchet with 72 fine-pitched teeth has a low return angle of only 5°. This short stroke allows fast and precise work in all types of installation. Ratchet can be used as a conventional screwdriver in 0° position by attaching a bitholder adaptor and a bit. The ball lock holds the socket and attachments securely, ensuring safe working. A changeover into any predefined position is completed by simply pressing the release button, this is even in the case in 90° position.



Article No.	Type	Description	IMPA
960075	8000A	Wera Zyklop Speed Ratched with 1/4" drive	-
960076	8000B	Wera Zyklop Speed Ratchet with 3/8" drive	-

### Wera Click-Torque adjustable Torque wrenches with reversible ratchet

The Wera range of Click-Torque reversible ratchet wrenches is available from 1/4" up to 3/4" square connection. Easy setting and saving of the desired torque value with audible and tactile clicks when reaching the scale values. Measuring ranges as per DIN EN ISO 6789-1:2017-07. With ergonomic 2-component handle suitable for right-hand use. Simple and safe, easy setting and saving of the desired torque value; readable on the main and fine scales. Very robust design with reversible ratchet (45 teeth) and ergonomic 2-component handle. Very fine graduation of 0.10 Nm (1/4"), 0.25 - 0.50 Nm (3/8"), 0.25 - 0.50 - 1.0 Nm (1/2), 1.0 Nm (3/4"). Precise 1/4" ±4% and for all 3/8" - 1/2" - 3/4" ±3% as per DIN EN ISO 6789-1:2017-07.

Article No.	Type	Description	IMPA
96W075604	A5	Click Torque A5 1/4" square drive 2.5-25 Nm (0.10 Nm) L= 290 mm	-
96W075605	A6	Click Torque A6 1/4" hex drive 2.5-25 Nm (0.10 Nm) L= 290 mm	-
96W075610	B1	Click Torque B1 3/8" square drive 10-50 Nm (0.25 Nm) L= 360 mm	-
96W075611	B2	Click Torque B2 3/8" square drive 20-100 Nm (0.50 Nm) L= 405 mm	-
96W075620	C1	Click Torque C1 1/2" square drive 10-50 Nm (0.25 Nm) L= 360 mm	-
96W075621	C2	Click Torque C2 1/2" square drive 20-100 Nm (0.50 Nm) L= 405 mm	-
96W075622	C3	Click Torque C3 1/2" square drive 40-200 Nm (1.0 Nm) L= 510 mm	-
96W075623	C4	Click Torque C4 1/2" square drive 60-300 Nm (1.0 Nm) L= 595 mm	-
96W075624	C5	Click Torque C5 1/2" square drive 80-400 Nm (1.0 Nm) L= 680 mm	-
96W075630	E1	Click Torque E1 3/4" square drive 200-1000 Nm (1.0 Nm) L= 1250mm	-



## Hand Tools WERA

### Wera Click-Torque Push R/L adjustable torque wrench

**For Clockwise and Anti-clockwise torque-control** thanks to the smooth reversing of the captive square head insert. Measuring range precise to  $\pm 3\%$  as per DIN EN ISO 6789-1:2017-07. Square head drive 45 teeth with socket locking. Easy setting and saving of the desired torque value with audible and tactile clicks when reaching the scale values. Audible and tactile release mechanism when the set torque value is reached. Very robust design with captive head insert, ergonomic 2-component handle.



Article No.	Type	Description	IMPA
96W075625	C2	Click Torque C2 1/2" square drive 20-100 Nm (0.5 Nm) L= 405 mm	-
96W075626	C3	Click Torque C3 1/2" square drive 40-200 Nm (1.0 Nm) L= 510 mm	-
96W075631	E1	Click Torque E1 3/4" square drive 200-1000 Nm (1.0 Nm) L= 1250mm	-



### Wera 8002 C Koloss All inclusive set with 1/2" drive + hammer head, 5 pcs and 3 pcs sets

For loads of at least 600 Newton metres. Push-through square drive for right/left switchover. Including hammer function. Multi-component Kraftform handle optimised to withstand pressure, impact and tensile loads. Fine-pitched ratchet mechanism, small return angle of 6°. Non-removable sealed and hardened square drive for tough jobs. Changing the ratchet direction using a hardened push-through square drive ensures great resilience since there is no susceptible switching mechanism that could be damaged by hammer blows. This is far more robust than a right/left switch. Tubular shaft minimises impact vibrations. Dry-fined hammer face used with rubber pad attachments to protect materials and surfaces. Robust dual ratchet, 30 saw teeth with the precision effect of 60 fine teeth with a 6° return angle.

Article No.	Type	Description	IMPA
96W133862	8002 C set 5 pcs	Wera 8002 C Koloss All Inclusive set 1/2", 5 pcs contains; 8002 C Koloss 1/2" drive ratched / hammer L= 341 mm 8782 C Koloss Pad Set 2 x 50 mm 8780 C Koloss extension 341x137 mm 8000 E Unlocking pin 40,5 mm Belt Holster 175 x 75 mm	-
96W036920	8002 C set 3 pcs	Wera 8002 C Koloss All Inclusive set 1/2", 3 pcs contains; 8002 C Koloss 1/2" drive ratched / hammer L= 341 mm 8782 C Koloss Pad Set 2 x 50 mm Belt Holster 175 x 75 mm	-
96W036950	8780 C	Wera 8780 C Koloss extension 341 x 137 mm	-
96W036960	8781 C	Wera 8781 C Koloss centring pin 135 mm to align lugs or drill holes. Out of tough, hardened chrome-molybdenum steel.	-
96W036970	8782 C	Wera 8782 C Koloss pad set made from flexible thermoplastic	-
96W136400	8000 E	Wera 8000 E Unlocking pin to unlock connection between Koloss 8002 C ratchet and Koloss 8780 C extension.	-

