

Duplex D-type strainer

D-typedual basket strainer 1" to 4" (25mm - 100mm) NB

Duplex strainers are used for pipelines operating continuously incorporating twin chambers each rated for 100% capacity. An integral flow changeover valve permits basket removal and cleaning without interruption of the flow. The range is designed to compliment the Simplex filters but allows the cleaning and replacement of the baskets carried out within any interruption to the flow through the filter. Fixed stops are provided to indicate which basket is in use. A projecting flange from the changeover handle guards the cover of the basket in use, making it possible to remove inadvertently.

Standard features:

Single lever action on changeover valve eliminates possibility of hydraulic lock and accidental interruption of the flow.

Fixed stops are provided to indicate which chamber is in use and a projecting flange from the valve lever guards the cover of the chamber in use to avoid the wrong cover from being inadvertently opened.

Quick release covers eliminate the need for tools for maintenance.

Basket area to pipe CSA of over 12:1.

Designed for pressure ratings up to ASMA class 300 (51 BARG).

Flow is from inside to outside of the basket to trap and retain debris.

Supplied with coarse perforated baskets (2mm as standard) or fine stainless steel inserts to give particles retention down to 45 microns.

Options:

Pleated baskets for high filtration areas.

Reinforced baskets for withstanding high differential pressures.

Magnetic element assemblies.

Flanged connection for drain, vent and ancillary connections.

Steam, hot water or oil jackets.

Supplied with ancillary equipment such as DP gauges and switches, valves for drains and vents.

Available in gunmetal, duplex stainless steel or other special alloys.

Design data:

Cast iron BS 1452 GR220, flanges ANSI 250 FF, design pressure 17.2 BARG (250 psig) @38°C.

Operating temperature 0°C to +120°C.

Cast steel ASTM A216 WCB, flanges ANSI 300 RF, design pressure 51 BARG (740 psig) @38°C.

Operating temperature 0°C to +200°C.

Stainless steel BS 1504 316 C16, flanges ANSI 300 RF, design pressure 51 BARG (740 psig) @38°C.

Operating temperature 0°C to +200°C.

All baskets and mesh inserts are made of Stainless steel AISI316.

Bridge on stainless steel filter is cast steel - (non contact part).



Dimensions:

SIZE		MODEL NO.	A MM	B MM	C MM	D MM	E MM	F MM	G BSPT	H BSPT	J BSPT	K MM	WEIGHT	
IN	MM												LB	KG
1 SCR*	25	1-DA	338	229	99	86	205	106	1/8"	1/4"	1/4"	133	51	23
1 1/2 SCR*	40	1.5-DA	338	229	102	108	223	157	1/8"	1/4"	1/4"	140	84	38
1	25	1-DA	338	229	108	111	205	106	1/8"	1/4"	1/4"	133	51	23
1 1/2	40	1.5-DA	338	229	108	121	223	157	1/8"	1/4"	1/4"	140	84	38
2	50	2-DA	327	219	130	149	274	179	1/4"	1/4"	1/2"	195	119	54
3	80	3-DA	454	305	183	233	333	286	1/4"	1/4"	1/2"	268	231	105
4	100	4-DA	643	432	186	268	399	370	1/4"	1/4"	1/2"	268	447	205

Type SCR is as screwed version (available in BSPF or NTPF and only in cast iron).

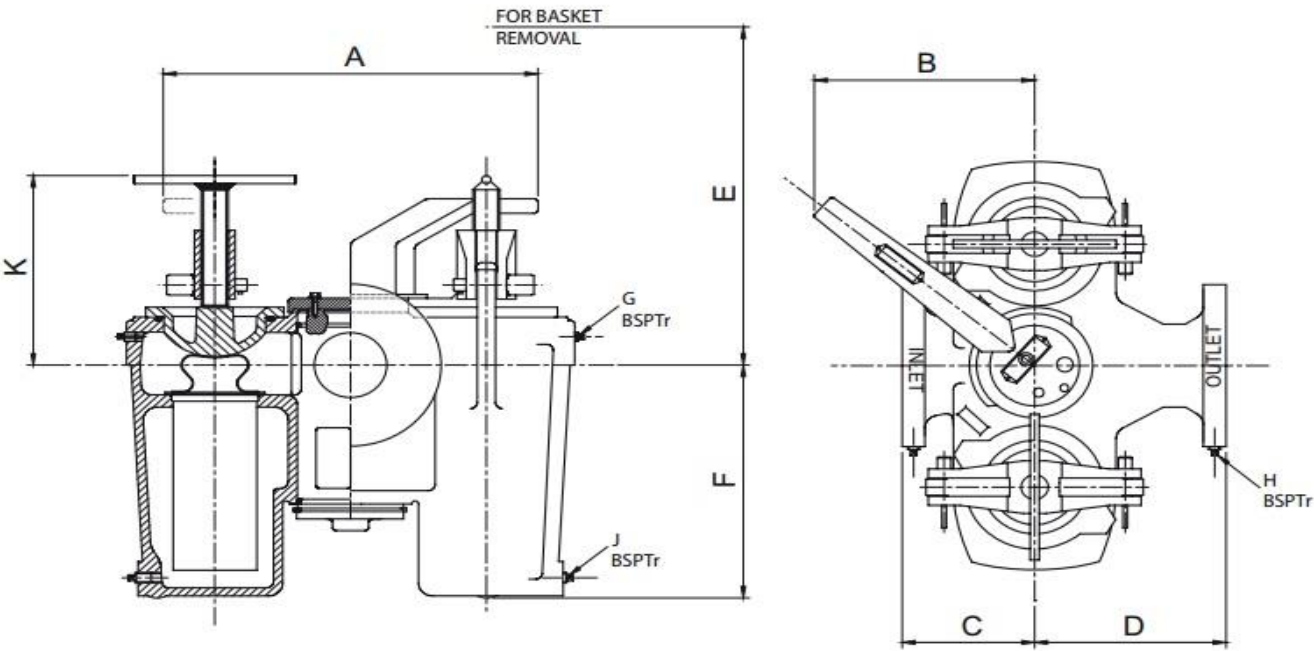

Number	Material house	Size Inch	Size mm	Model
43SPXF0231500	Cast Iron	1" (SCR)	25 mm	1-DA
43SPXF0231505	Cast Iron	1.1/2" (SCR)	40 mm	1.5-DA
43SPXF0231510	Cast Iron	1"	25 mm	1-DA
43SPXF0231515	Cast Iron	1.1/5"	40 mm	1.5-DA
43SPXF0231520	Cast Iron	2"	50 mm	2-DA
43SPXF0231530	Cast Iron	3"	80 mm	3-DA
43SPXF0231540	Cast Iron	4"	100 mm	4-DA
43SPXG0231510	Cast Steel	1"	25 mm	1-DA
43SPXG0231515	Cast Steel	1.1/5"	40 mm	1.5-DA
43SPXG0231520	Cast Steel	2"	50 mm	2-DA
43SPXG0231530	Cast Steel	3"	80 mm	3-DA
43SPXG0231540	Cast Steel	4"	100 mm	4-DA
43SPXH0231510	Stainless Steel	1"	25 mm	1-DA
43SPXH0231515	Stainless Steel	1.1/5"	40 mm	1.5-DA
43SPXH0231520	Stainless Steel	2"	50 mm	2-DA
43SPXH0231530	Stainless Steel	3"	80 mm	3-DA
43SPXH0231540	Stainless Steel	4"	100 mm	4-DA

Simplex S-type strainers

Simplex S-type filters of simple and robust construction with in line connections and can be used in liquids and gases. The Simplex (single) basket type is for general applications where the process flow is intermittent and can be stopped for element cleaning.

Standard features:

Quick release covers eliminate the need for tools for maintenance.

Designed for pressure ratings up to ASME class 300 (51 BARG).

Flow from inside to outside the basket to trap and retain debris.

High basket area to pipeline C.S.A. ratio of over 10:1.

With coarse perforated baskets (2 mm as standard) or fine stainless steel mesh inserts to give particle removal down to 50 microns.

Disposable depth type cartridges are available for filtration to 5-10 micron on liquid and 1-2 micron on gases.

All fitted with cleanable baskets and inserts or disposable gas cartridges as required, in cast iron, cast steel and stainless steel.

Options:

Complying with current Transco specifications.

Can be supplied complying with PD5500 or ASME VIII design codes.

Pleated baskets for high filtration areas.

Reinforced baskets for withstanding high differential pressures.

Magnetic element assemblies.

Flanged connection for drain, vent and ancillary connections.

Steam, hot water or hot oil jackets.

Supplied with ancillary equipment such as DP gauges and switches, air release heads, valves for vent and drains etc.

Available in gunmetal, duplex stainless steel or special alloys.

250 mm and 300 mm cast steel units available full ASME klasse 300 rating (51 BARG design).

Design data:

All design pressures are BARG @ 38°C.

Design pressure will reduce by flange drilling to a lesser standard.

Cast iron BS 1452 GR220/260, 25 & 40 mm flanges ASME 250 FF*, design pressure 20.6 BARG.

* = also available with screwed ends.

Cast iron BS 1452 GR220/260, 50 to 150 mm flanges ASME 250 FF*, design pressure 20.6 BARG.

Cast iron BS 1452 GR220/260, 250 mm flanges ASME 200 FF*, design pressure 12 BARG.

Cast iron BS 1452 GR220/260, 25 & 300 mm flanges ASME 125 FF*, design pressure 12 BARG.

Cast steel ASTM A216 WCB, 25 & 40 mm flanges ASME 300 RF, design pressure 34.4 BARG.

Cast steel ASTM A216 WCB, 50 to 150 mm flanges ASME 300 RF, design pressure 51 BARG.

Cast steel ASTM A216 WCB, 200 mm flanges ASME 300 RF, design pressure 51 BARG.

Cast steel ASTM A216 WCB, 250 & 300 mm flanges ASME 150 RF**, design pressure 19.6 BARG.

** = also available with ASME 300 RF flanges @ 51/49.6 BARG design pressure.

Stainless steel BS 1504 316 C16, 25 & 40 mm flanges ASME 300 RF, design pressure 34.47 BARG.

Stainless steel BS 1504 316 C16, 50 to 150 mm flanges ASME 300 RF, design pressure 51 BARG.

Stainless steel BS 1504 316 C16, 200 mm flanges ASME 300 RF, design pressure 51 BARG.

Stainless steel BS 1504 316 C16, 250 & 300 mm flanges ASME 300 RF, design pressure 19 BARG.



Dimensions:

Simplex Type S Filter 1" & 1½" (25 & 40mm) Screwed (cast iron only)

SIZE		MODEL NO.	A MM	B MM	C MM	D MM	E MM	F BSPT	WEIGHT	
IN	MM								LB	KG
1	25	SN-1	162	98	102	14	83	1/2"	11	5
1½	40	SN-1.5	171	149	102	73	83	1/2"	13	6

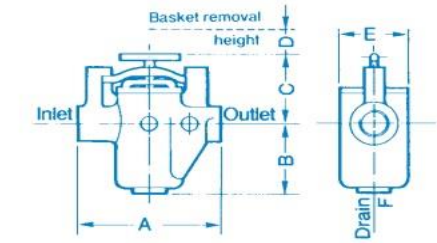

Simplex Type S Filter 1" & 1½" (25 & 40mm) Flanged

SIZE		MODEL NO.	A MM	B MM	C MM	D MM	E MM	F BSPT	WEIGHT	
IN	MM								LB	KG
1	25	SN-1	162	98	102	14	83	1/2"	18	8
1½	40	SN-1.5	216	149	102	73	156	1/2"	28	12.5

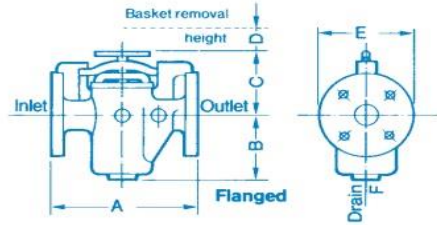

Simplex Type S Filter 2"-8" (50-200mm)

SIZE		MODEL NO.	A MM	B MM	C MM	D MM	E MM	F BSPT	WEIGHT	
IN	MM								LB	KG
2	50	SN-2	292	192	198	122	165	1 1/4"	51	23
3	75	SN-3	362	270	251	138	210	1 1/4"	101	45
4	100	SN-4	425	371	297	120	254	1 1/2"	181	82
6	150	SN-6	584	514	349	260	318	1 1/2"	435	197
8	200	SN-8	711	699	422	464	381	1 1/2"	800	364

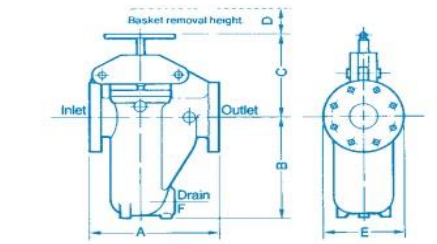

Simplex Type S Filter 10"-12" (250-300mm)

SIZE		MODEL NO.	A MM	B MM	C MM	D MM	E MM	F BSPT	WEIGHT	
IN	MM								LB	KG
10	250	SN-10	864	790	150#-556	150#-744	457	2"	990	450
12	300	SN-12	864	790	300#-635	300#-665	521	2"	1070	486

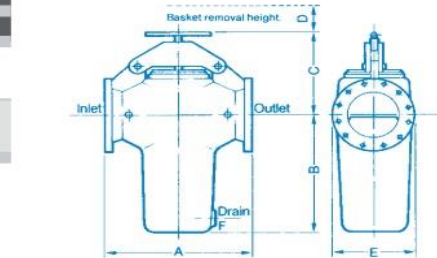

Number	Material house	Size Inch	Size mm	Model
43SPXF0251500	Cast Iron	1" (SCR)	25 mm	SN-1
43SPXF0251505	Cast Iron	1.1/2" (SCR)	40 mm	SN-1.5
43SPXF0251510	Cast Iron	1"	25 mm	SN-1
43SPXF0251515	Cast Iron	1.1/5"	40 mm	SN-1.5
43SPXF0251520	Cast Iron	2"	50 mm	SN-2
43SPXF0251530	Cast Iron	3"	75 mm	SN-3
43SPXF0251540	Cast Iron	4"	100 mm	SN-4
43SPXF0251550	Cast Iron	6"	150 mm	SN-6
43SPXF0251560	Cast Iron	8"	200 mm	SN-8
43SPXF0251580	Cast Iron	10"	250 mm	SN-10
43SPXF0251590	Cast Iron	12"	300 mm	SN-12
43SPXG0251510	Cast Steel	1"	25 mm	SN-1
43SPXG0251515	Cast Steel	1.1/5"	40 mm	SN-1.5
43SPXG0251520	Cast Steel	2"	50 mm	SN-2
43SPXG0251530	Cast Steel	3"	80 mm	SN-3
43SPXG0251540	Cast Steel	4"	100 mm	SN-4
43SPXG0251550	Cast Steel	6"	150 mm	SN-6
43SPXG0251560	Cast Steel	8"	200 mm	SN-8
43SPXG0251580	Cast Steel	10"	250 mm	SN-10
43SPXG0251590	Cast Steel	12"	300 mm	SN-12

Number	Material house	Size Inch	Size mm	Model
43SPXH0251510	Stainless Steel	1"	25 mm	SN-1
43SPXH0251515	Stainless Steel	1.1/5"	40 mm	SN-1.5
43SPXH0251520	Stainless Steel	2"	50 mm	SN-2
43SPXH0251530	Stainless Steel	3"	80 mm	SN-3
43SPXH0251540	Stainless Steel	4"	100 mm	SN-4
43SPXH0251550	Stainless Steel	6"	25 mm	SN-6
43SPXH0251560	Stainless Steel	8"	40 mm	SN-8
43SPXH0251580	Stainless Steel	10"	50 mm	SN-10
43SPXH0251590	Stainless Steel	12"	80 mm	SN-12

Filmet Symplex filters

The filmet range of filters has been designed specifically for applications where there are high flow rates requiring high efficiency filtration whilst maintaining extremely low pressure loss characteristics.

It is ideally suited for flow meter protection for high value product, and is equally suitable for turbine, positive displacement and orifice plate types of flow meters.

Standard features:

Quick release covers eliminate the need for tools for maintenance.

Very large basket filtration area to pipe CSA ratio up to 25:1.

Flow from inside to outside of basket to trap and retrain debris.

Fitted with 2 mm perforated stainless steel basket.

A range of fine stainless steel mesh inserts to give particle removal down to 50 micron.

No spillage of product when cover is removed for basket cleaning.

Drain and gauge tappings are available as required.

Simple robust construction.

Available in Cast Iron or Cast Steel.

Design data:

Flanges drilled to customer requirements.

All baskets & mesh inserts are 316SS.

Cast Iron BS 1452 GR220, 2.1/2" 65 mm flanges ASME B16.1 Classe 125 FF, design pressure 12 BARG.

Cast Iron BS 1452 GR220, 3" 75 mm flanges ASME B16.1 Classe 125 FF, design pressure 12 BARG.

Cast Iron BS 1452 GR220, 4" 100 mm flanges ASME B16.1 Classe 125 FF, Design pressure 12 BARG.

Cast Iron BS 1452 GR220, 6" 150 mm flanges ASME B16.1 Classe 125 FF, design pressure 10.3 BARG.

Cast steel ASTM A216 WCB, 2.1/2" 65 mm flanges ASME B16.1 Classe 300 RF, design pressure 24 BARG.

Cast steel ASTM A216 WCB, 3" 75 mm flanges ASME B16.1 Classe 300 RF, design pressure 24 BARG.

Cast steel ASTM A216 WCB, 4" 100 mm flanges ASME B16.1 Classe 300 RF, design pressure 24 BARG.

Cast steel ASTM A216 WCB, 6" 150 mm flanges ASME B16.1 Classe 300 RF, design pressure 24 BARG.

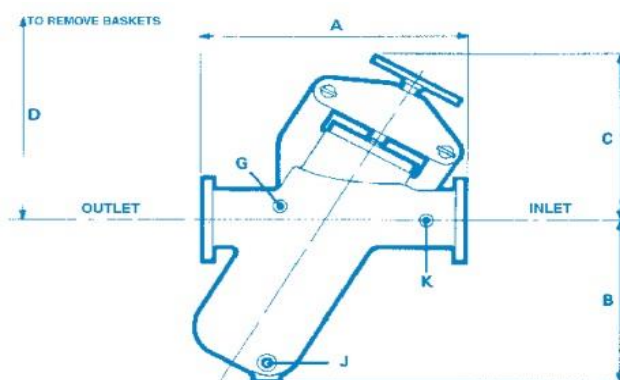

SIZE		CAST IRON BS 1452 GR 220		CAST STEEL ASTM A216 WCB	
		FLANGE RATING	DESIGN PRESSURE	FLANGE RATING	DESIGN PRESSURE
IN	MM	ASME B16.1 CLASS 125 FF	12 BARG	ASME B16.5 CLASS 300 RF	24 BARG
2½	65		12 BARG		24 BARG
3	75		12 BARG		24 BARG
4	100		12 BARG		24 BARG
6	150		10.3 BARG		24 BARG

Nummer	Materiaal huis	Maat Inch	Maat mm	Model
43SPXF0351520	Cast Iron	2.1/2"	65 mm	PF-2.5
43SPXF0351530	Cast Iron	3"	75 mm	PF-3
43SPXF0351540	Cast Iron	4"	100 mm	PF-4
43SPXF0351550	Cast Iron	6"	150 mm	PF-6
43SPXG0351520	Cast Steel	2.1/2"	65 mm	PF-2.5
43SPXG0351530	Cast Steel	3"	75 mm	PF-3
43SPXG0351540	Cast Steel	4"	100 mm	PF-4
43SPXG0351550	Cast Steel	6"	150 mm	PF-6

Simplex Basket type strainer

These fabricated carbon steel strainers incorporate all of the standard Plenty features common on the Simplex range. They have been designed for use on gas and liquids, with sizes from 6" to 24" and capable of flows up to 2000 m³/hr. The filtration area is up to 12 times the pipe cross-sectional area and the welded construction gives flexibility in design with respect to flow, pressure, material and design code.

Standard features:

Quick release covers eliminate the need for tools for maintenance.
Flow is from inside the basket to outside to trap and retrain all debris.
High basket area to pipeline C.S.A. ratio of over 16:1 in most cases.
Supplied with coarse perforated baskets (2 mm as standard) or fine stainless steel mesh inserts to give particle removal down to 50 microns.
Disposable depth type cartridges are available for filtration to 5-10 micron on liquid and 1~2 micron on gases.

Options:

Complying with the current Transco specifications.
Can be supplied with PD5500 or ASME VIII design codes.
Pleated baskets for high filtration areas.
Reinforced baskets withstanding high differential pressures.
Magnetic element assemblies.
Flanged connection for drain, vent and ancillary connections.
Supplied with ancillary equipment such as DP gauges and switches, air release heads, valves for vent and drains etc.
Available in stainless steel or specialalloys.

Single filter basket

Dimensions 6", 8", 10" and 12" nominal bore.
Working pressure standard to 18.9 BARG @38°C.
Custom made applications to 49.6 BARG @38°C.

Dimensions:

A	558 MM	22 1/4"
B	965 MM	38"
C	640 MM	25 1/4"
D	914 MM	36"
E	914 MM	36"
WEIGHT UP TO 540 KG (1190 LB)		

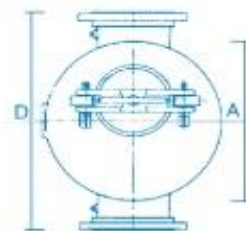

Two filter basket

Dimensions 8", 10", 12", 14" and 16" nominal bore
Working pressure standard to 18.9 BARG @38°C.
Custom made applications to 34.4 BARG @38°C.

Dimensions:

A	813 MM	32 1/4"
B	838 MM	33"
C	646 MM	25 1/4"
D	1066 MM	42"
E	795 MM	30 1/4"
WEIGHT UP TO 1180 KG (2600 LB)		

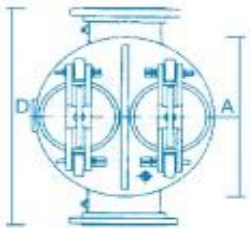

Three filter basket

Dimensions 12", 14", 16" and 18" nominal bore
Working pressure standard to 18.9 BARG @38°C.
Custom made applications to 34.4 BARG @38°C.

Dimensions:

A	1066 MM	42 1/4"
B	838 MM	33"
C	743 MM	29 1/4"
D	1524 MM	60"
E	800 MM	31 1/2"
WEIGHT UP TO 1870 KG (4115 LB)		

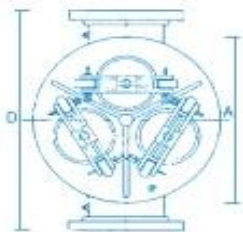

Four filter basket

Dimensions 14", 16", 18", 20" and 24" nominal bore
Working pressure standard to 18.9 BARG @38°C.

Dimensions:

A	1168 MM	46 1/4"
B	838 MM	33"
C	743 MM	32 1/4"
D	1524 MM	60"
E	800 MM	36 5/8"
WEIGHT UP TO 2270 KG (4990 LB)		

