

TEP Ex ATEX LED Linear light fitting
Explosion-Proof LED Lighting

TYPE FLX 310 LED Zone 1, 21, 2, 22



Construction:

Housing: Aluminium powder painted casting
 Diffuser: Borosilicate glass
 Accessories: Protected galvanized steel gird, assembly kit for wall, pipe and ceiling mounting.
 Gasket: Silicone

Technical data:

Certificate: FIDI 19 ATEX 0045X
 Marking: CE 0722
 Apparatus category: II 2G
 II 2D
 Marking of Ex protection: Ex db eb op is IIC T6 Gb
 Ex tb op is IIIC T80°C Db
 Ambient temperature ATEX: From -20°C ≤ Ta ≤ +50°C
 Degree of protection: IP 66 category 1
 Resistance to shock: IK 08
 Protection class: I (protective earthing)
 Rated voltage: 220-240V
 110V on request
 Frequency: 50/60 Hz
 Rated power: 80W, 100W
 Connection terminals: L1, L2, L3, N; max 2x2,5mm²
 PE terminal; max 2x6mm²
 External PA terminal -PA; max 2x6mm²
 Cable entry: 2x M20 or 2x 3/4" NPT, with one Ex d plug and one adapter type ADP 03/24 for cable ø6-15mm
 Weight: 7 kg
 Mounting: Pedant, on pipe, wall, ceiling. Operates in any position.



High colour rendering index CRI 80
 Estimated service life ≥50.000 hours at Ta 40°C
 LED 3x12W chip-on-board technology with OVP, OCP, OTP protection
 Autonomous reactivation after recovery
 Suitable for linear lighting up to 20 modules
 Color temperature 4000K

Number	Model	Wattage	Lumen	lm/W	Ambient temp. °C
83TEP055042	FLX 310 LED	38W	3.240	85	-20 to +50
83TEP055042W2	FLX 310 LED With 2 cable glands	38W	3.240	85	-20 to +50

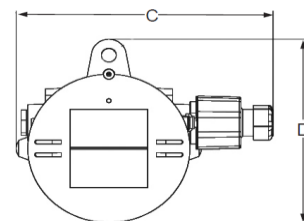
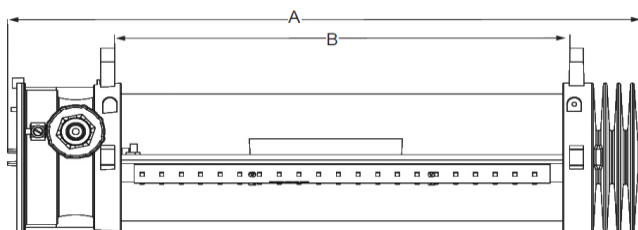
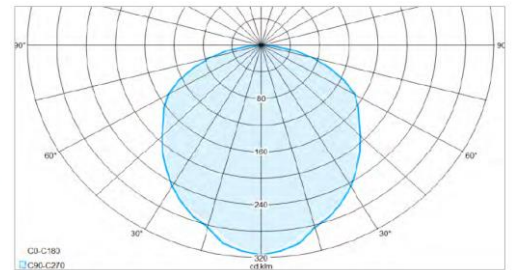

A	B	C	D
550	395	223	173

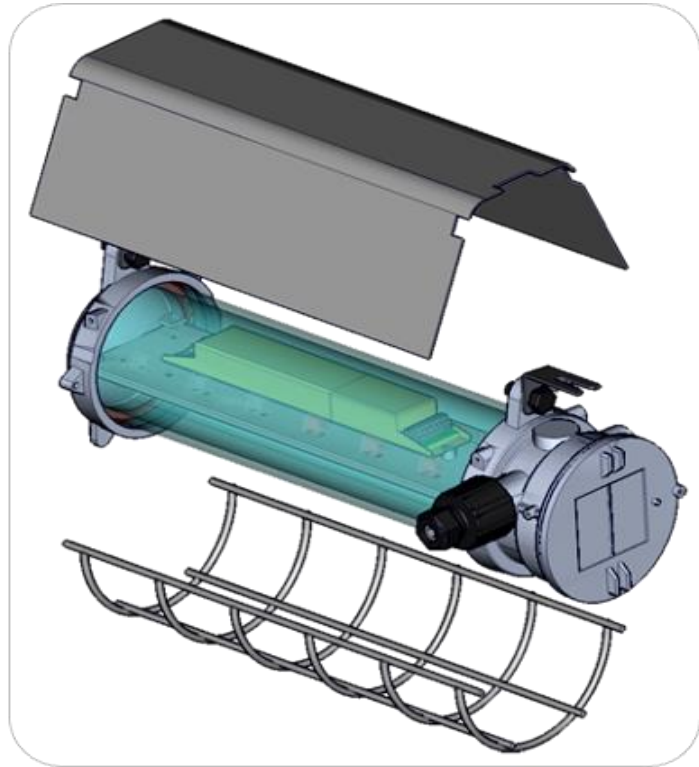
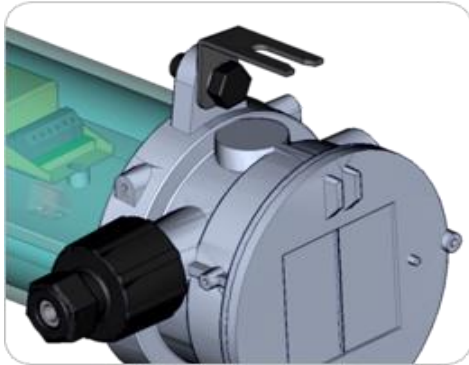

Standard spares and accessories

Number	Model	Description
83TEPFLX10120	FLX1 0-120	Cover gasket FLX
83TEPFLXLED10310	FLX LED10-130	LED Module FLX 310
83TEPFLXLED20140	FLX LED20-140	Protective grid FLX set
83TEPFLXLED20150	FLX LED20-150	External reflector FLX
83TEPFLX20170	FLX 20-170	Mounting set FLX for wall/ceiling
83TEPFLX20180	FLX 20-180	Mounting set FLX for pipes

Accessories for MARINE Environments.

Number	Model	Description
83TEP055042CL	FLXSSCL	Mounting bracket 121-127mm Stainless steel AISI316 (A4) M8/M10 combi nut. (2 pcs needed per luminaire). NEVER INSTALL OUTSIDE IN MARINE ENVIRONMENTS WITHOUT THIS BRACKETS this protect the luminaire against bi-metallic corrosion.

